

ACCESSORIES STANDARD

SNI 06-0135-1987 / ISO 4422-1990

Long Bend Rubber Ring Socket / Spigot 90°

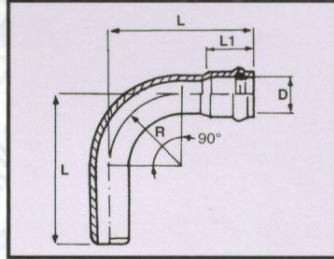

D	L1	R	L
63	70	190	318
75	110	200	400
90	120	205	415
110	140	320	540
125	150	375	600
160	170	440	720
200	200	500	1300
250	260	900	1600
315	320	1150	1600
355	340	1150	2250
400	420	1200	2350

Long Bend All Rubber Ring Socket 45°

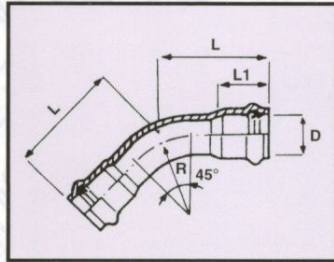

D	L1	R	L
63	70	190	250
75	110	200	300
90	120	205	325
110	140	320	375
125	150	375	450
160	170	440	550
200	200	500	650
250	260	900	1200
315	320	1150	1200
355	340	1150	2000
400	420	1200	2200

Long Bend Solvent Cement Socket/Spigot 22,5°

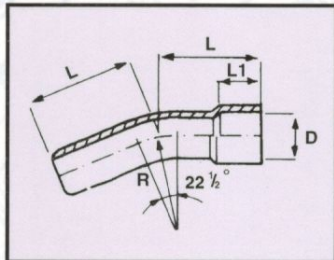

D	L1	R	L
63	50	190	200
75	70	200	250
90	75	205	275
110	85	320	325
125	110	375	400
160	140	440	500
200	170	500	600

Long Bend All Solvent Cement Socket 11,25°

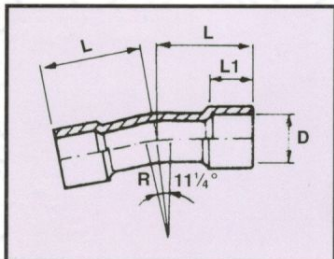

D	L1	R	L
63	50	190	180
75	70	200	230
90	75	205	255
110	85	320	300
125	110	375	375
160	140	440	450
200	170	500	500

Tee Socket All Rubber Ring

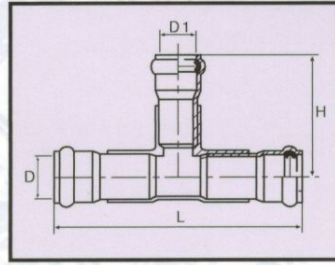

D - D1	L	H
63 - 63	325	160
75 - 75	440	215
90 - 63	475	190
90 - 90	475	255
110 - 63	550	203
110 - 90	550	270
110 - 110	600	305
160 - 63	840	280
160 - 90	840	340
160 - 110	840	360
160 - 160	840	400
200 - 110	1010	475
200 - 160	1010	495
200 - 200	1010	510

Tee Socket All Solvent Cement Joint

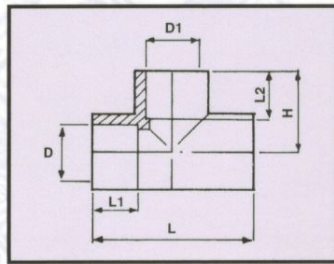

D - D1	L1	L2	L	H
20 - 20	16	16	56	28
25 - 16	19	14	60	30
25 - 20	19	16	62	34
25 - 25	19	19	66	33
32 - 16	22	14	79	31
32 - 25	22	19	72	36
32 - 32	22	22	77	38
40 - 40	26	26	96	48

D - D1	L1	L2	L	H
50 - 16	31	14	115	40
50 - 25	31	19	115	44
50 - 32	31	22	115	47
50 - 50	31	31	114	57
63 - 63	60	60	185	90
75 - 75	70	70	220	105
90 - 63	70	60	215	115
90 - 90	70	70	215	125
110 - 63	90	60	250	130
110 - 90	90	70	250	140
110 - 110	93	93	300	155
160 - 63	140	60	460	145
160 - 90	140	70	460	150
160 - 110	140	90	460	190
160 - 160	140	140	460	210
200 - 90	170	70	570	240
200 - 110	170	90	570	250
200 - 160	170	140	570	275
200 - 200	170	170	570	290

Flange Socket Rubber Ring

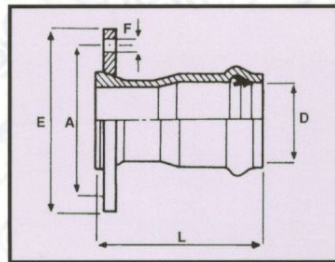

D	L	A	E	F	NO OF HOLES
63	140	125	165	18	4
90	180	160	200	18	8
110	210	180	220	18	8
160	255	240	285	22	8
200	300	295	335	22	8
250	360	325	370	22	8
315	450	400	445	22	16
355	470	460	515	22	16
400	570	515	575	22	16

Flange Spigot

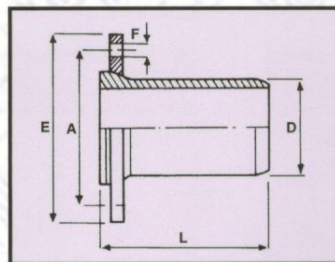
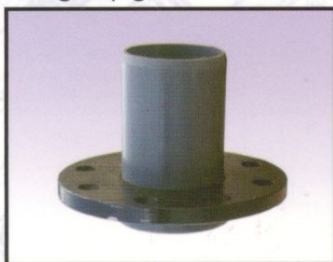

D	L	A	E	F	NO OF HOLES
63	146	125	165	18	4
90	173	160	200	18	8
110	192	180	220	18	8
160	245	240	285	22	8
200	286	295	335	22	8
250	300	325	370	22	8
315	350	400	445	22	16
355	380	460	515	22	16
400	410	515	575	22	16

Reducer Socket All Rubber Ring

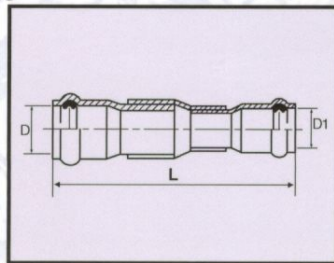
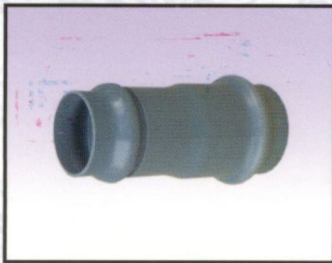

D - D1		L
90 -	63	368
110 -	63	413
110 -	90	470
160 -	90	585
160 -	110	640
200 -	110	820
200 -	160	850

Socket All Rubber Ring

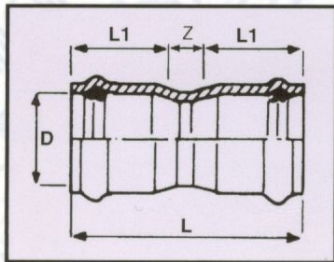

D	L1	L	Z
63	70	173	33
75	110	280	40
90	120	280	40
110	140	330	50
125	150	360	60
160	170	410	70
200	200	470	70
250	260	590	70
315	320	710	70
355	340	610	70
400	420	910	70

Repair Collar All Rubber Ring

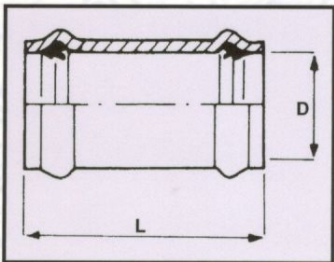

D	L
63	190
75	210
90	220
110	250
125	270
160	320
200	380
250	410
315	530
355	580
400	700

Socket All Solvent Cement

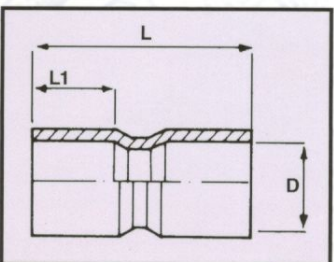
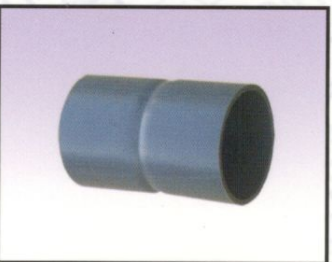

D	L1	L
63	50	110
75	70	160
90	75	180
110	85	200
125	110	250
160	140	310
200	170	370

Dop Rubber Ring

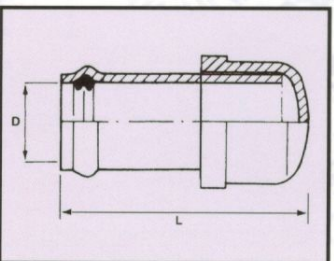

D	L
63	140
75	190
90	205
110	260
160	340

Produced by:

PT. INDRASARI KENCANA

PVC Pipe, PE Pipe & Garden Hose Industry

Office : Jln. Puri No. 57-G Medan 20215

Tel : (061) 736 9919 - 734 9710, Fax : (061) 732 2191

Factory : Jln. Sentosa No. 19 Binjai Km.12 Medan Indonesia

E-mail:info@finnlon.com

E-mail:pipafinnlon@gmail.com

Distributor :



PT. INDRASARI KENCANA